



PLANNING COMMITTEE

Tuesday 10 March 2015 at 6.00 pm

Council Chamber, Ryedale House, Malton

Agenda

13 **Late Observations**

(Pages 2 - 5)

Agenda Item 13

RYEDALE
DISTRICT
COUNCIL



Please Contact: Mrs Karen Hood
Extension 386
Email: karen.hood@ryedale.gov.uk

All Members of the Planning Committee
Council Solicitor
Head of Planning & Housing
Development Manager
Managing Development Team Leader

Ref: Agendas/Planning/2014/2015

6 March 2015

Dear Councillor

Meeting of the Planning Committee - 10 March 2015

With reference to the above meeting I enclose for your attention the late observations received since despatch of the agenda.

Yours sincerely

A handwritten signature in black ink, appearing to read 'K Hood'.

Mrs Karen Hood
Managing Development Team Leader

Enc

Natalie Meynell

To: Alan Hunter
Subject: RE: 14/02147/FUL - Land Adjacent to 8 New Road Kirkbymoorside

From: Paul Smith
Sent: 05 March 2015 12:35
To: Alan Hunter
Cc: Dick Page
Subject: 14/02147/FUL - Land Adjacent to 8 New Road Kirkbymoorside

Good afternoon Alan

Further to our telephone conversation I can confirm that the applicant wishes to withdraw the proposed garage/workshop from the application.

You can therefore disregard drawing number 6971_03_P_C which illustrates plans and elevations of the proposed garage/workshop.

I have attached to this email a revised location and block plan reflecting the withdrawal of the garage/workshop from the application – 6971_02_S10_C.

The applicant is pleased that the application has officer support and is recommended to Planning Committee for approval.

In view of this support we will not be speaking in favour of the application on Tuesday evening.

Many thanks for your help and support.

If you need anything further please do not hesitate to contact me.

Best wishes.

Paul Smith

BA (Hons) BSc (Hons) MCIAT
Managing Director
Molior Green Limited
E – paul.smith@moliorgreen.co.uk
W – www.moliorgreen.co.uk

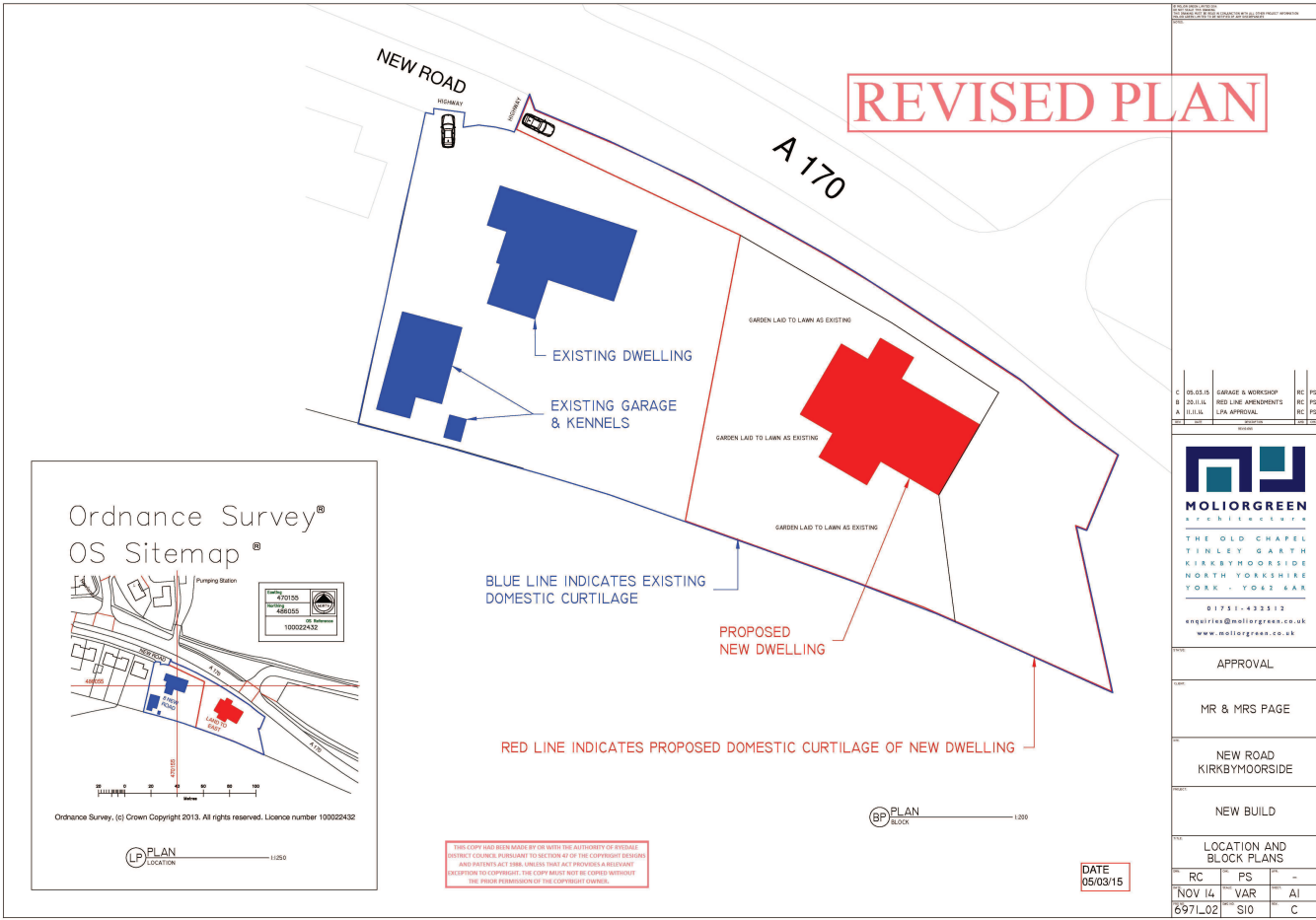

REVISED PLAN

NEW ROAD
A 170

EXISTING DWELLING
EXISTING GARAGE & KENNELS

PROPOSED NEW DWELLING

BLUE LINE INDICATES EXISTING DOMESTIC CURTILAGE

RED LINE INDICATES PROPOSED DOMESTIC CURTILAGE OF NEW DWELLING

GARDEN LAID TO LAWN AS EXISTING

GARDEN LAID TO LAWN AS EXISTING

GARDEN LAID TO LAWN AS EXISTING

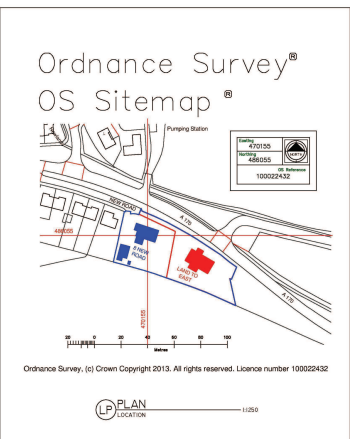

THIS COPY HAS BEEN MADE BY OR WITH THE AUTHORITY OF REVOLUTIONARY DESIGN CONSULTANTS TO SECTION 41 OF THE COPYRIGHT ACTS 1988 AND PATENTS ACT 1988, UNLESS THAT ACT PROVIDES A RELEVANT EXCEPTION TO COPYRIGHT. THE COPY MUST NOT BE COPIED WITHOUT THE PRIOR PERMISSION OF THE COPYRIGHT OWNER.

PLAN 1:250

DATE 05/03/15

C	05.03.15	GARAGE & WORKSHOP	RC	PS
B	20.11.14	RED LINE AMENDMENTS	RC	PS
A	03.10.14	LPA APPROVAL	RC	PS
MOLIORGREEN				
THE OLD CHAPEL KIRKBY MOORSIDE NORTH YORKSHIRE YORK - YO42 6AR 01753 432312 enquiries@moliorgreen.co.uk www.moliorgreen.co.uk				
APPROVAL				
MR & MRS PAGE				
NEW ROAD KIRKBYMOORSIDE				
NEW BUILD				
LOCATION AND BLOCK PLANS				
RC	PS	-	-	-
NOV 14	VAR	AI	-	-
697L02	SIO	C	-	-

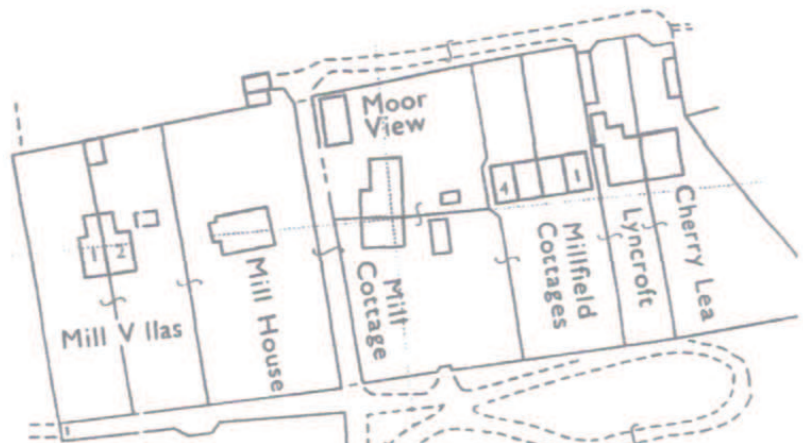

REVISED

THIS COPY HAS BEEN MADE BY OR WITH THE AUTHORITY OF THE DISTRICT COUNCIL PURSUANT TO SECTION 61 OF THE EVIDENCE ACT 1924 AND IT IS HEREBY DECLARED THAT NOTWITHSTANDING ANYTHING TO THE CONTRARY CONTAINED IN ANY INSTRUMENT OR DOCUMENT THIS COPY SHALL REMAIN VALID AND CORRECT IN ALL RESPECTS AND SHALL BE TREATED AS SUCH FOR ALL PURPOSES.

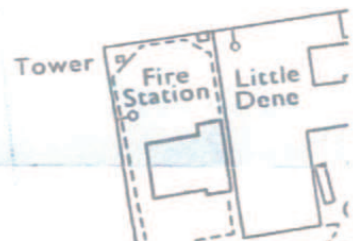

B M 40.28m

39.4m +

HIGH STREET

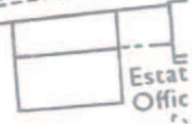

SCALE 1:1250